

## Alphalink Cem – Step by Step Anleitung

Einsetzen von Restaurationen mit Sebond Universal und Alphalink Cem.

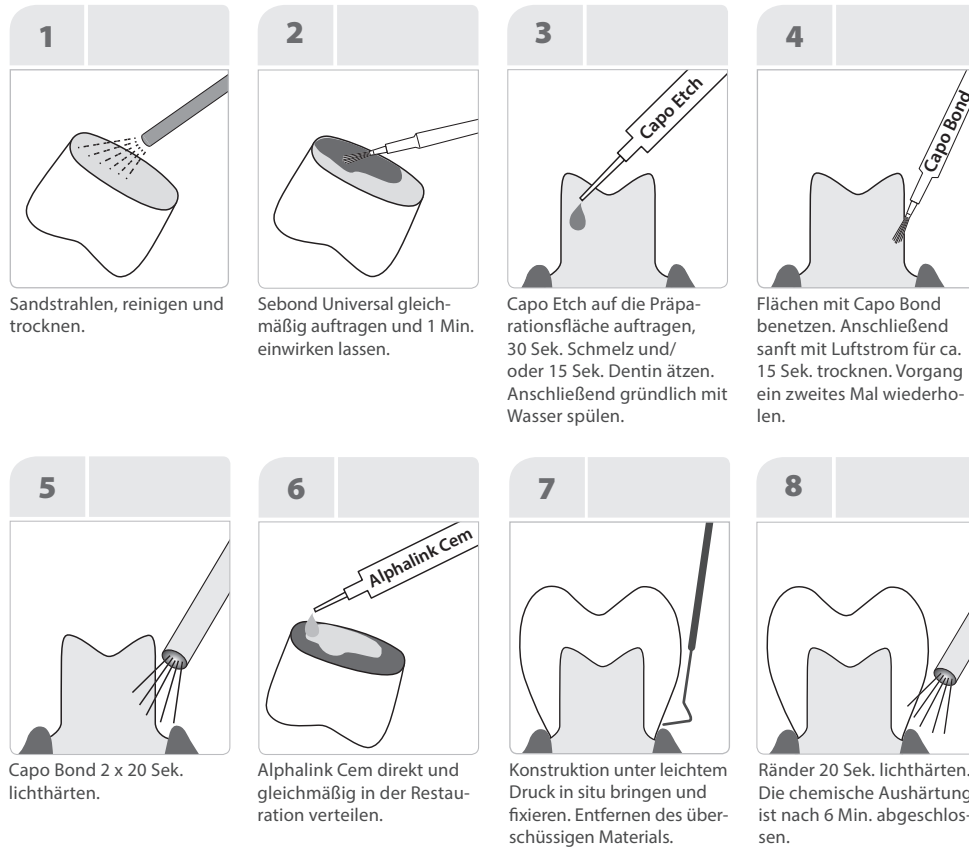

Ersetzt nicht die Verarbeitungsanleitung. Bitte beachten Sie die vollständige Verarbeitungsanleitung Alphalink Cem. Die Verantwortung liegt beim Behandler.

CE 0297

**SCHÜTZ DENTAL**  
Micerium Group

Schütz Dental GmbH • Dieselstr. 5-6 • 61191 Rosbach/Germany  
Tel. +49 (0) 6003 814-0 • Fax +49 (0) 6003 814-906  
www.schuetz-dental.de • info@schuetz-dental.de

Mandler 01/2021 – 500

## Alphalink Cem – Step by Step Anleitung

Befestigen von Wurzelstiften mit Alphalink Cem

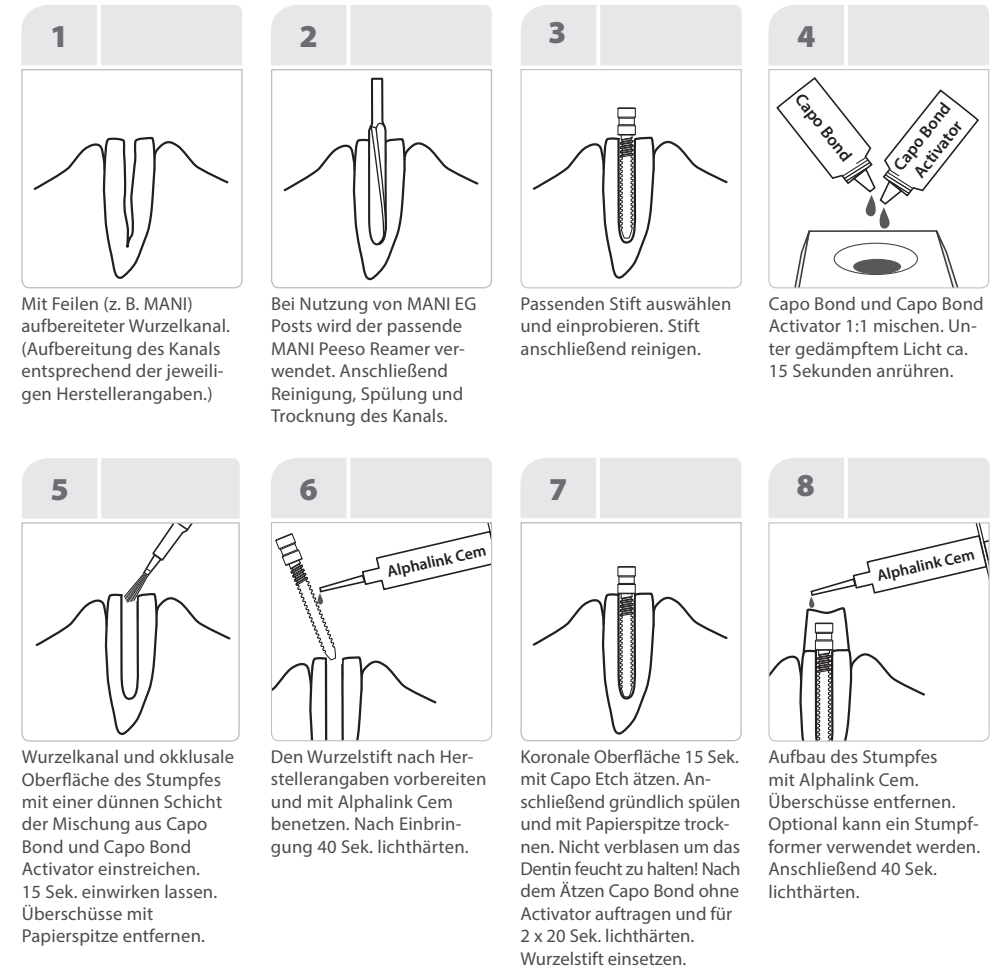

Ersetzt nicht die Verarbeitungsanleitung. Bitte beachten Sie die vollständige Verarbeitungsanleitung Alphalink Cem. Die Verantwortung liegt beim Behandler.

## Alphalink Cem – Step by Step Instructions

Inserting restorations with Sebond Universal and Alphalink Cem.

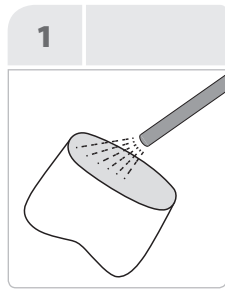

1 Sandblasting, cleaning and drying.



2 Apply Sebond Universal evenly and leave for 1 min.

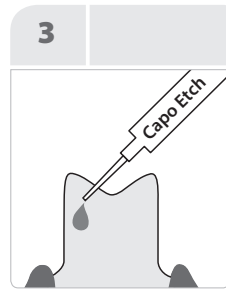

3 Apply Capo Etch to the preparation surface. Etch enamel for 30 sec. and/ or dentin for 15 sec. Subsequently, rinse well with water.

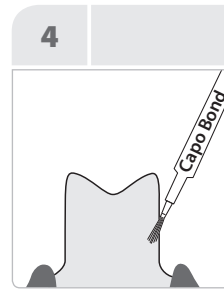

4 Wet surfaces with Capo Bond. Subsequently, dry gently with compressed air for approx. 15 sec. Repeat procedure twice.

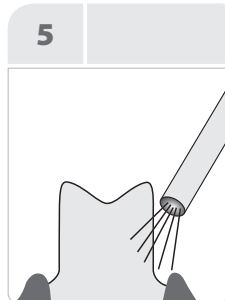

5 Cure Capo Bond with a polymerization lamp for 2 x 20 sec.



6 Spread Alphalink Cem directly and evenly on the restoration.

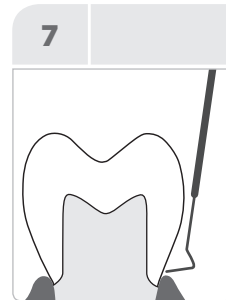

7 Apply slight pressure to the unit in situ and fix in place. Remove excess material.

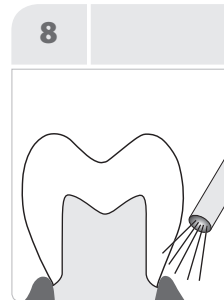

8 Cure margins with a polymerization lamp for 20 sec. Chemical polymerization is complete after 6 min.

Does not replace the instructions for use. Please also see the full Alphalink Cem instructions for use. The responsibility lies with the attending dentist.

CE 0297

**SCHÜTZ DENTAL**  
Micerium Group

Schütz Dental GmbH • Dieselstr. 5-6 • 61191 Rosbach/Germany  
Tel. +49 (0) 6003 814-365 • Fax +49 (0) 6003 814-907  
www.schuetz-dental.com • export@schuetz-dental.de

Mandler 01/2021 – 500

## Alphalink Cem – Step by Step Instructions

Securing dental pins with Alphalink Cem

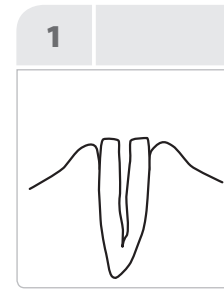

1 Root canal debried with files (e.g. MANI). (Canal debried in accordance with manufacturer's instructions.)

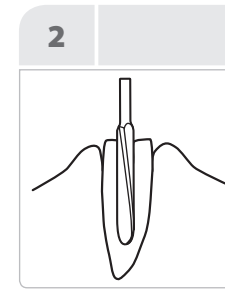

2 If using MANI EG posts, employ the right MANI Peeso Reamer. Subsequently, clean, rinse and dry the canal.

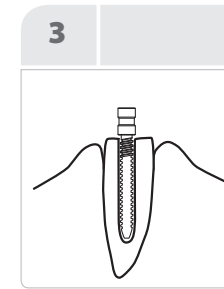

3 Select the appropriate pin and try in. Subsequently, clean the pin.

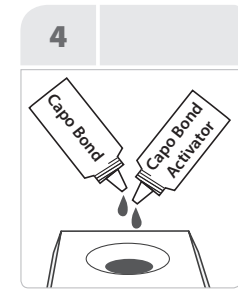

4 Mix Capo Bond and Capo Bond Activator 1:1. Agitate for approx. 15 seconds in subdued light.

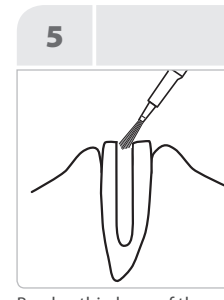

5 Brush a thin layer of the Capo Bond and Capo Bond Activator mixture on the root canal and occlusal surface of the stump. Leave for 15 sec. Remove excess material with paper points.

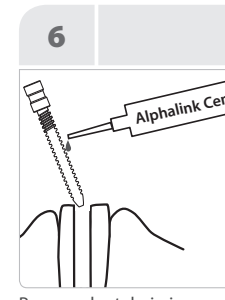

6 Prepare dental pin in accordance with manufacturer's instructions and wet with Alphalink Cem. Once mounted, cure with a polymerization lamp for 40 sec.

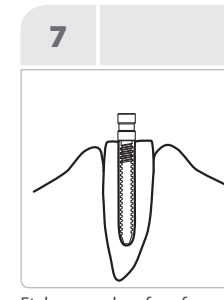

7 Etch coronal surface for 15 sec. with Capo Etch. Subsequently, rinse well and dry with paper point. Do not blow dry, to keep the dentine moist. After etching, apply Capo Bond without activator and cure with a polymerization lamp for 2 x 20 sec. Insert dental pin.



8 Build up the stump with Alphalink Cem. Remove excess material. A stump shaper may optionally be used. Subsequently, cure with a polymerization lamp for 40 sec.

Does not replace the instructions for use. Please also see the full Alphalink Cem instructions for use. The responsibility lies with the attending dentist.

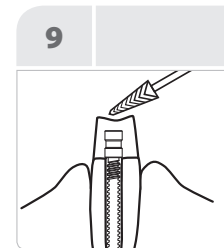

9 Chemical polymerization is complete after 6 min. Finish and polish stump if required.